

URINE SPECIMEN COLLECTION KIT INSTRUCTIONS

Please carefully read all instructions. Failure to follow instructions may lead to incorrect results. For complete details and tips for best results when collecting your specimen, please watch our video at testandgo.com/testandgo-tests

Questions: Contact us at testandgo.com or call (800) 402-0000.

BEFORE RETURNING KIT, CONFIRM:

- ✓ **KIT WAS ACTIVATED.** The specimen cannot be processed if the kit is not activated.
- ✓ **DATE OF BIRTH and INITIALS** are written on the tube label.
- ✓ **TUBE IS SEALED** in the provided specimen bag with absorbent pad.
- ✓ You will drop off the specimen on the **SAME DAY** it is collected.

KIT CONTENTS



KIT PACKAGE



COLLECTION CUP



PIPETTE



TUBE



SPECIMEN BAG WITH ABSORBENT PAD



LABEL WITH QR CODE



SANITIZER WIPES



RETURN MAILER



PEN

KIT INSTRUCTIONS

1 Activate Kit

- Scan the QR Code on the tube label in the kit.
- If you cannot scan the label, call our helpline to complete this step: 800-402-0000.



2 Fill out label

The lab can only process the specimen if the correct information is written on the label.

- Write the **initials** and **date of birth** of the person being tested on the tube label.



3 Place label on tube

- Place label on the tube as shown.



4 Clean hands

Anyone touching supplies must clean their hands. Use sanitizer/wipe or wash hands with soap and warm water for 20 seconds and dry them thoroughly with a clean towel.



5 Open collection cup package

Remove the collapsible collection cup from the package and expand fully.

6 Collect urine sample

- Do not urinate for at least one hour prior to specimen collection.
- No cleansing of the genital area should occur prior to specimen collection.
- First-void of initial urine stream should be collected in the cup. Fill the collection cup no more than halfway (finish voiding outside of the cup and into the toilet). Collection of larger volumes can reduce test sensitivity.



7 Transfer urine

- Unscrew the cap of the transport tube to prepare it for your sample.
- Take care not to spill the fluid that is in the tube. This is essential for obtaining accurate test results.
- Use the pipette to transfer urine from the collection cup into the transport tube.

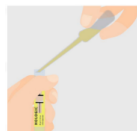

8 Check level then seal tightly

- Keep adding urine until you have hit the minimum fill line.
- Do not exceed the maximum fill line.
- When you have enough urine, screw the cap on tightly.

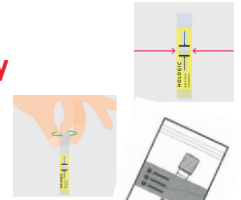

9 Clean hands

Before returning the collected specimen to the kiosk, use hand sanitizer/sanitizer wipe to clean your hands.



10 Return specimen

The specimen **MUST** be dropped off the same day it is collected.

- Leave the absorbent pad in the bag.
- Place the tube in the specimen bag and seal the bag securely.
- Place the specimen bag into the prepaid mailer and seal.
- Deposit the sealed mailer into a FedEx drop off box or at a FedEx ship location immediately OR deposit in the return drawer of the kiosk.



WHEN YOUR RESULTS ARE READY YOU WILL RECEIVE A TEXT OR EMAIL. IF YOU DO NOT RECEIVE YOUR RESULTS WITHIN 48 HOURS OF LAB RECEIVING YOUR SPECIMEN, PLEASE CALL 800-402-0000 FOR ASSISTANCE.

PLEASE READ:

Seek immediate medical care from a healthcare professional if seriously ill - do NOT wait for the results of this test. Call 9-1-1 if having a medical emergency.